



AIR CLEANER RETROFIT KIT

FASTAIR



MERC

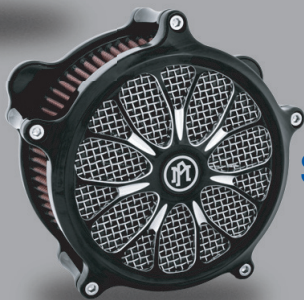

SUPERGAS

PERFORMANCE MACHINE LIMITED WARRANTY INFORMATION

Performance Machine warrants to the original purchaser that the parts of this AC retrofit kit to be free of manufacturing defects in materials and workmanship for a period of one (1) year from the date of purchase. In the event warranty service is required, you must call Performance Machine immediately with a description of the problem.

If it is deemed necessary for Performance Machine to make an evaluation to determine whether the part is defective, a return authorization number will be given by Performance Machine. The parts must be packaged properly so as to not cause further damage and returned prepaid to Performance Machine with a copy of the original invoice of purchase and a detailed letter outlining the nature of the problem. If after the evaluation by Performance Machine the part was found to be defective it will be repaired or replaced at no cost to you. If we replace it, we may replace it with a reconditioned one of the same design.

Performance Machine shall not be held liable for any consequential or incidental damages resulting from the failure of a Performance Machine part.

Performance Machine shall have no obligation if a part becomes defective as a result of improper installation or abuse.

PM AIR CLEANER RETROFIT KIT INSTALLATION

During the next few steps you will be replacing the existing breather bolts from your Performance Machine air cleaner with new, slotted head versions, and adding some rubber breather tubes. This kit has been designed to help direct any top end oil overflow back into your engine and prevent any external leakage.

SUPERGAS & MERC

NOTE: Upon assembly use blue 243 loctite on all fasteners

1. Turn your motorcycle off. Extinguish all cigarettes and open flames.
2. Remove the five 1/4-20 x 2-1/2" bolts, outer plate, wire mesh (Supergas Only), foam ring, air filter, five spacers, secondary plate, and both "smooth head" breather bolts.
3. Install new "slotted head" breather bolts (10). Make sure the breather bolts are centered in the machined recesses, this will allow proper function of the rubber breather tubes. Using blue "Loctite 243", torque to 15 lb./ft.
4. Install the new rubber breather tubes (13 & 14) as shown in figure A. They should fit snugly into the machined recesses.
5. Replace the secondary plate and ensure that it sits flat and there is no obstruction from the breather tubes below.
6. Reinstall the air filter element and all other front cover components .
7. Install the five 1/4-20 x 2-1/2" bolts using blue "Loctite 243" and torque to 8 lb./ft.
8. Installation is now complete. Fire up your Performance Machine and take it for a ride.

FASTAIR

NOTE: Upon assembly use blue 243 loctite on all fasteners

1. Turn your motorcycle off. Extinguish all cigarettes and open flames.
2. Remove the 3 1/4-20 bolts fastening the complete outer air filter assembly (do not remove the spokes, air filter, elbow, or filter covers). Remove the secondary plate and remove the "smooth head" breather bolts.
3. Install new "slotted head" breather bolts (10). Make sure the breather bolts are centered in the machined recesses, this will allow proper function of the rubber breather tubes. Using blue "Loctite 243", torque to 15 lb./ft.
4. Install the new rubber breather tubes (13 & 14) as shown in figure A. They should fit snugly into the machined recesses.
5. Replace the secondary plate and ensure that it sits flat and there is no obstruction from the breather tubes below.
6. Reinstall the complete air filter assembly using the 3 existing bolts and torque to 8 lb-ft. .
7. Installation is now complete. Fire up your Performance Machine and take it for a ride.



FIG. A



AC RETROFIT KIT INSTALLATION

FRONT COVER DESIGN
MAY VARY DEPENDING
ON PART NUMBER.

SUPERGAS

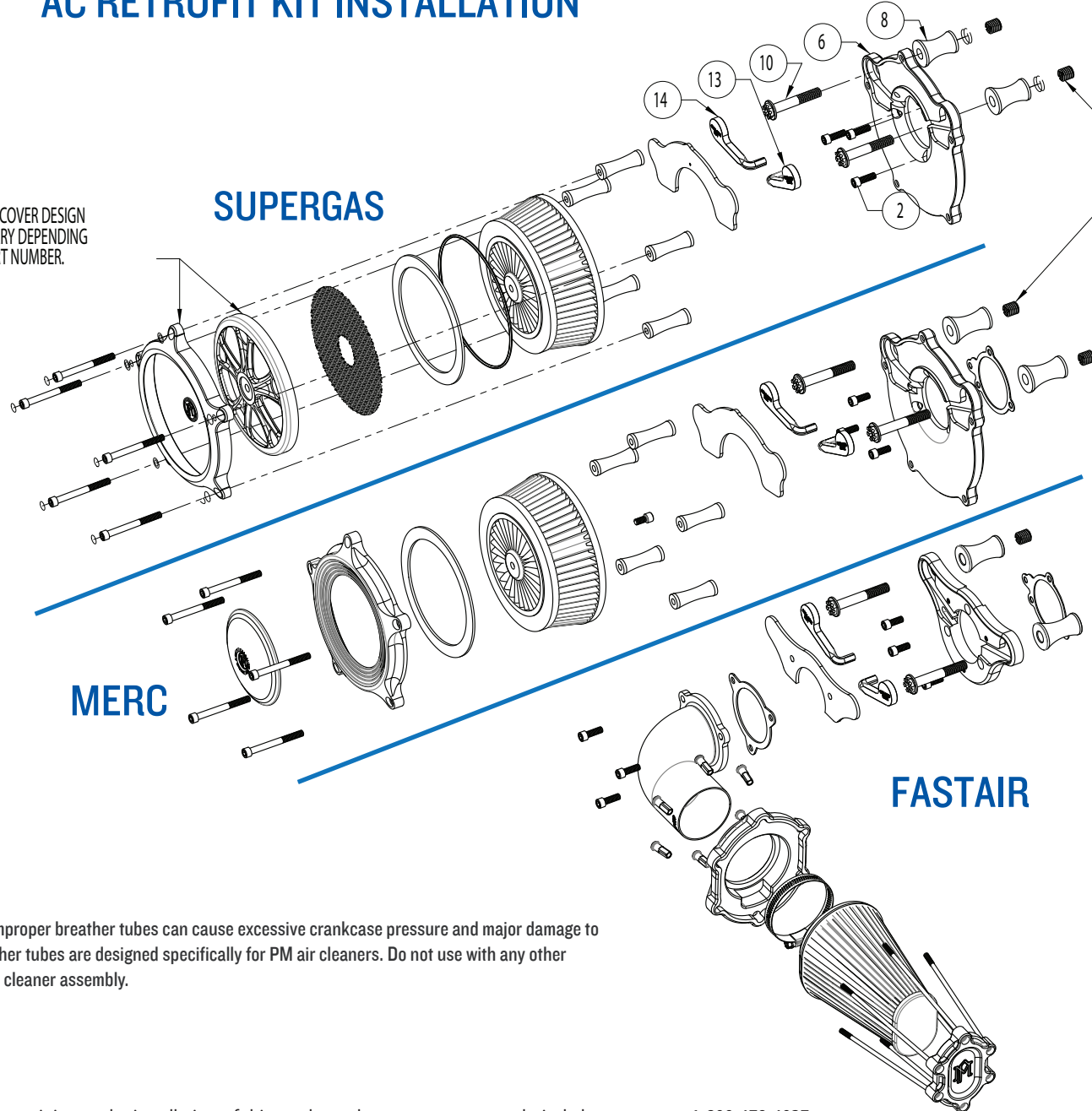

93-99 BIG TWIN EVO
MODELS ONLY.
NOT INCLUDED IN
SPORTSTER AIR
CLEANERS.

MERC

FASTAIR

NOTE: Using the improper breather tubes can cause excessive crankcase pressure and major damage to your engine. Breather tubes are designed specifically for PM air cleaners. Do not use with any other manufacturer's air cleaner assembly.